

# WESTWOOD MIDDLE SCHOOL

## PHASE I (770) STUDENT STATIONS



## SUMMARY OF UNITS

42	MODULAR CLASSROOMS (36'X24')
2	MODULAR P.E. (36'X24')
0	SKILLS (36'X24')
1	CLINIC (36'X24')
0	ART (36'X24')
1	CHORAL (36'X24')
1	MUSIC (36'X70')
1	MEDIA (36'X93')
2	ADMIN (36'X60')
1	DINING HALL/WARMING KIT. (36'X105')
0	KITCHEN & DRY STORAGE (36'X84')
6	RESTROOM (12'X36')
1	COVERED P.E. PAVILION

NOTE: (46) TOTAL MODULAR CLASSROOMS 36'X24'

# WESTWOOD MIDDLE SCHOOL PHASE I (770) STUDENT STATIONS

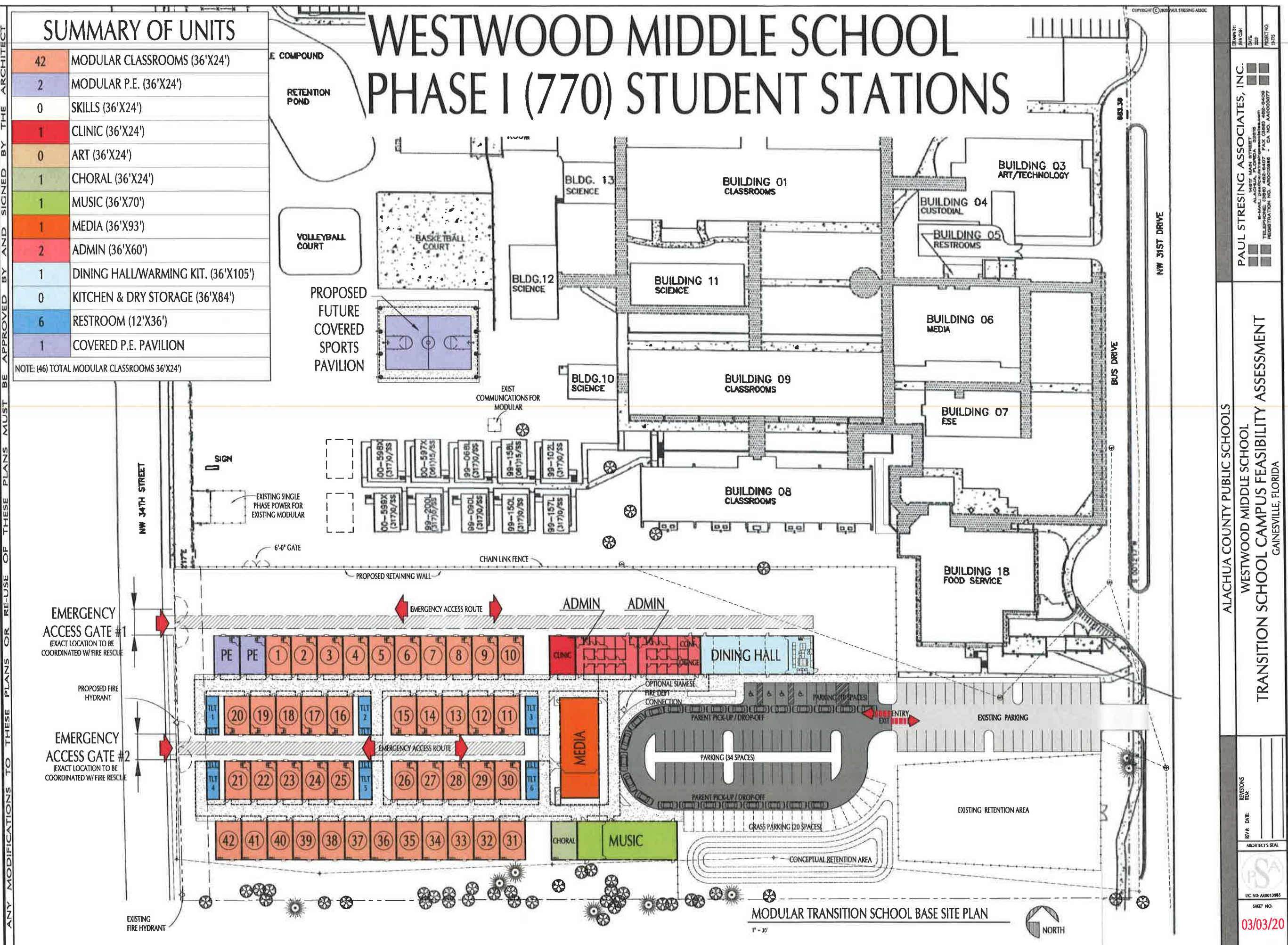

MODULAR TRANSITION SCHOOL BASE SITE PLAN

1" = 30'



ALACHUA COUNTY PUBLIC SCHOOLS

WESTWOOD MIDDLE SCHOOL  
TRANSITION SCHOOL CAMPUS FEASIBILITY ASSESSMENT  
GAINESVILLE, FLORIDA

REVISIONS

DATE

ARCHITECT'S SEAL



LIC. NO. AR0012985

SHEET NO.

03/03/20

PAUL STRESING ASSOCIATES, INC.  
ALACHUA, FLORIDA 32015  
TELEPHONE: 352-442-1407 FAX: 352-442-8409  
REGISTRATION NO. AR0012985 CA. NO. A0003377



ANY MODIFICATIONS TO THESE PLANS OR RE-USE OF THESE PLANS MUST BE APPROVED BY AND SIGNED BY THE ARCHITECT

# WESTWOOD SCHOOL SITE

## SITE ADVANTAGES

- 1 POSSIBILITY OF SHARING KITCHEN ELIMINATING NEED TO PURCHASE A FOOD PREP UNIT
- 2 NO ADDITIONAL GREASE TRAPS AND MAINTENANCE
- 3 SHARED BUS DRIVE WITH STAGGERED START TIMES
- 4 POSSIBLE USE OF ADJACENT PARK FOR BUS STAGING
- 5 CENTRAL LOCATION (WESTWOOD & LITTLEWOOD) BENEFITS
- 6 SCHOOL TO RECEIVE A NEW COVERED P.E. PAVILION
- 7 SITE RESTORATION TO INCLUDE NEW SPORTS FIELDS
- 8 NO NEW ROAD CUTS WILL BE REQUIRED
- 9 770 STUDENT STATIONS IS MAX SIZE OF SCHOOL NEEDED (WESTWOOD MIDDLE SCHOOL CAN USE SOME EXISTING BUILDINGS AND ALL CURRENT PORTABLES DURING CONSTRUCTION)
- 10 THE WESTWOOD STUDENTS WILL NOT HAVE TO BE RELOCATED
- 11 CAR & BUS TRAFFIC WOULD BE MANAGEABLE W/ LAW ENFORCEMENT OFFICER CONTROL DURING SCHOOL PEAKS
- 12 LITTLEWOOD / WESTWOOD SCHOOL WALKING ZONES TO REMAIN UNDISTURBED
- 13 FEWER STUDENTS WOULD REQUIRE BUSSING

## SITE DISADVANTAGES

- 1 STAGGERED START SCHEDULE
- 2 SITE WILL REQUIRE SEWER LIFT STATION
- 3 SITE WILL REQUIRE RETAINING WALLS TO ACCOMMODATE GRADE AND ELEVATION CHANGES
- 4 THIS IS THE MOST CHALLENGING SITE W/ RESPECT TO CONSTRUCTION EFFORTS BECAUSE OF SITE WORK
- 5 SHARED EXISTING BUS LOOP ONLY HOLDS 7 BUSES
- 6 SHARED SCHOOL SECURITY ENHANCEMENT (SCHOOL FENCING & ADMIN PRESENCE) TO SUBDIVIDE THE SCHOOL ( MIDDLE SCHOOL TO MIDDLE SCHOOL VS. MIDDLE SCHOOL TO ELEMENTARY SCHOOL)
- 7 TEMPORARY REDUCTIONS OF USE OF FULL SPORTS FIELDS WHILE TRANSITION SCHOOL IS ACTIVE
- 8 CITY PREPARING FOR A PARK CONSTRUCTION ENHANCEMENT PROJECT (COULD HINDER BUS OPERATIONS FOR 6 TO 8 MONTHS)
- 9 NEED FOR LAW ENFORCEMENT OFFICER TRAFFIC CONTROL EFFORTS AT NW 31ST DRIVE AT 16TH AVE AND 8TH AVE DURING SCHOOL PEAKS
- 10 COST OF ADDITIONAL SIDEWALK ALONG 31ST DRIVE NEAR BUS LOOP

PAUL STRESING ASSOCIATES, INC.

ALACHUA COUNTY PUBLIC SCHOOLS  
WESTWOOD MIDDLE SCHOOL  
TRANSITION SCHOOL CAMPUS FEASIBILITY ASSESSMENT  
GAINESVILLE, FLORIDA

REVISIONS  
REV # DATE

ARCHITECT'S SEAL

IPSA  
LIC. NO. A00011111

SHEET NO

03/03/20



Copyright © 2010 PAUL STREIBING ASSOC.

REVISIONS ITEM: _____ REV # DATE: _____ _____ _____ _____		ARCHITECT'S SEAL <div style="text-align: center;">  </div> LIC. NO. AR0013965 SHEET NO.	
WESTWOOD MIDDLE SCHOOL TRANSITION SCHOOL CAMPUS FEASIBILITY ASSESSMENT GAINESVILLE, FLORIDA		PAUL STRESING ASSOCIATES, INC. <div style="text-align: center;">  </div> 3000 N. UNIVERSITY AVENUE ALBUQUERQUE, NEW MEXICO 87106 E-MAIL: paul@paulstresing.com TEL: 505.263.4400 FAX: 505.263.4400 REGISTRATION NO. A0003306 / CA. NO. A0003377	

ANY MODIFICATIONS TO THESE PLANS OR RE-USE OF THESE PLANS MUST BE APPROVED BY AND SIGNED BY THE ARCHITECT





SUMMARY OF UNITS	
42	MODULAR CLASSROOMS (36'X24')
2	MODULAR P.E. (36'X24')
0	SKILLS (36'X24')
1	CLINIC (36'X24')
0	ART (36'X24')
1	CHORAL (36'X24')
1	MUSIC (36'X70')
1	MEDIA (36'X93')
2	ADMIN (36'X60')
1	DINING HALL/WARMING KIT. (36'X105')
1	KITCHEN & DRY STORAGE (36'X84')
6	RESTROOM (12'X36')
0	COVERED P.E. PAVILION
NOTE: (46) TOTAL MODULAR CLASSROOMS (36'X24')	

**HOWARD BISHOP MIDDLE SCHOOL**  
PHASE I (770) STUDENT STATIONS



Q:\ACTIVE PROJECTS\2019\19-777 ALACHUA CO PORTABLE SWING SCHL CAMPUS\19-777 HOWARD BISHOP SITE\19-777\_A03 - PHASE 1.dwg, 3/3/2020 2:49:58 PM, Adobe PDF

ANY MODIFICATIONS TO THESE PLANS OR REUSE OF THESE PLANS MUST BE APPROVED BY AND SIGNED BY THE ARCHITECT

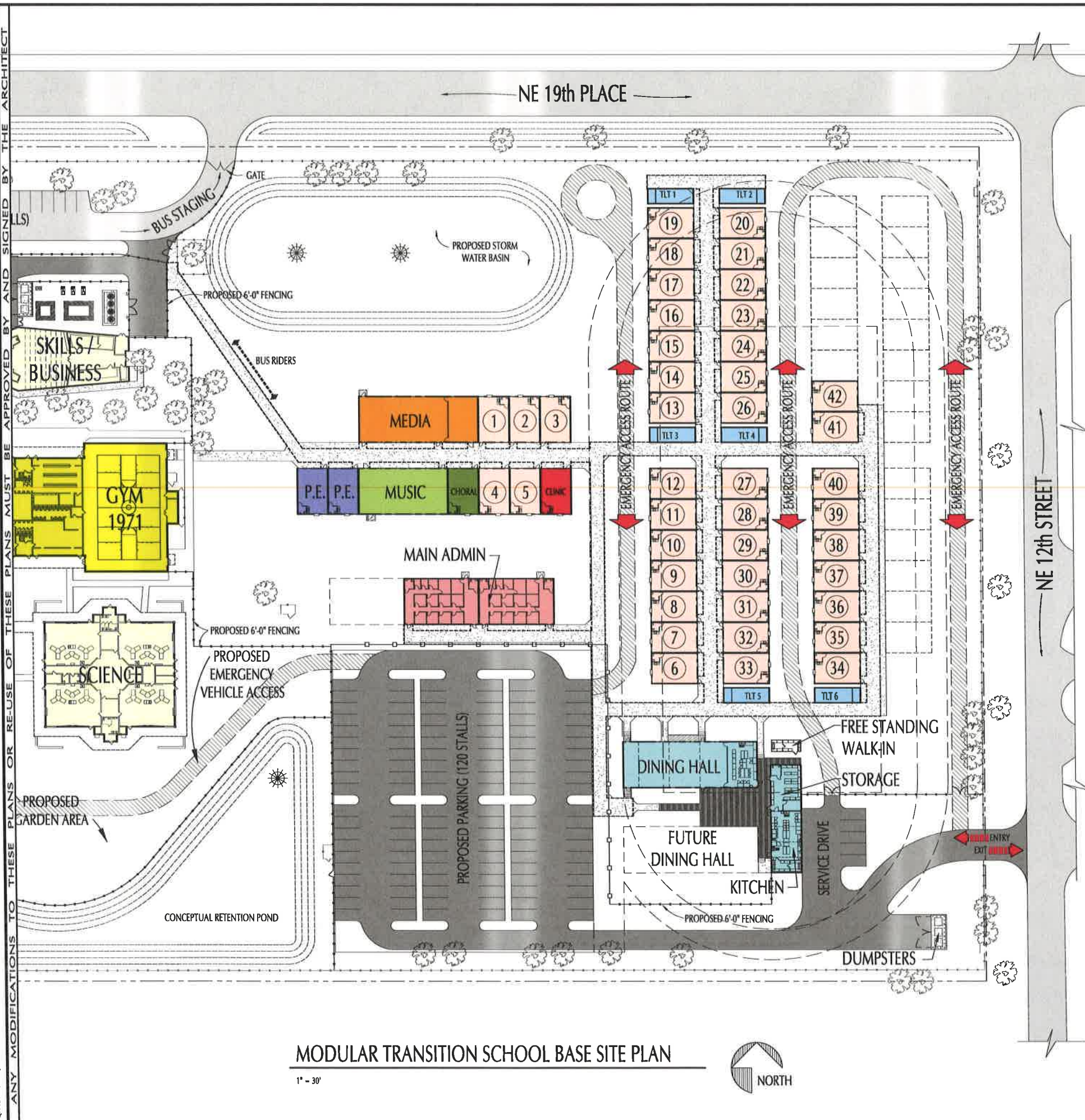

MODULAR TRANSITION SCHOOL BASE SITE PLAN

1" = 30'



SUMMARY OF UNITS	
42	MODULAR CLASSROOMS (36'X24')
2	MODULAR P.E. (36'X24')
0	SKILLS (36'X24')
1	CLINIC (36'X24')
0	ART (36'X24')
1	CHORAL (36'X24')
1	MUSIC (36'X70')
1	MEDIA (36'X93')
2	ADMIN (36'X60')
1	DINING HALL/WARMING KIT. (36'X105')
1	KITCHEN & DRY STORAGE (36'X84')
6	RESTROOM (12'X36')
0	COVERED P.E. PAVILION

NOTE: (46) TOTAL MODULAR CLASSROOMS (36'X24')

# HOWARD BISHOP MIDDLE SCHOOL PHASE I (770) STUDENT STATIONS

COPYRIGHT © 2020 PAUL STRESING ASSOC.

PAUL STRESING ASSOCIATES, INC.  
1000 N. W. 10th Ave., Suite 1000  
Fort Lauderdale, FL 33304  
Tel: 954.462.8400 Fax: 954.462.8401  
www.paulstresing.com

ALACHUA COUNTY PUBLIC SCHOOLS  
HOWARD BISHOP MIDDLE SCHOOL  
TRANSITION SCHOOL CAMPUS FEASIBILITY ASSESSMENT  
GAINESVILLE, FLORIDA

REVISIONS  
REV. DATE: \_\_\_\_\_  
ARCHITECT'S SEAL  
LIC. NO. AB0013383  
SHEET NO.  
03 / 03 / 20





SUMMARY OF UNITS	
59	MODULAR CLASSROOMS (36'X24')
2	MODULAR P.E. (36'X24')
2	SKILLS (36'X24')
1	CLINIC (36'X24')
1	ART (36'X24')
1	CHORAL (36'X24')
1	MUSIC (36'X70')
1	MEDIA (36'X93')
3	ADMIN (36'X60')
2	DINING HALL/WARMING KIT. (36'X105')
1	KITCHEN & DRY STORAGE (36'X84')
6	RESTROOM (12'X36')
0	COVERED P.E. PAVILION
NOTE: (66) TOTAL MODULAR CLASSROOMS (36'X24')	

**HOWARD BISHOP MIDDLE SCHOOL**  
PHASE II (1200) STUDENT STATIONS



Q:\ACTIVE PROJECTS\2019\1918-777 ALACHUA CO PORTABLE SWING SCHL CAMPUS\1918-777 ALACHUA CO PORTABLE SWING SCHL CAMPUS.dwg, 3/3/2020 2:52:07 PM, Adobe PDF

ANY MODIFICATIONS TO THESE PLANS OR REUSE OF THESE PLANS MUST BE APPROVED BY AND SIGNED BY THE ARCHITECT

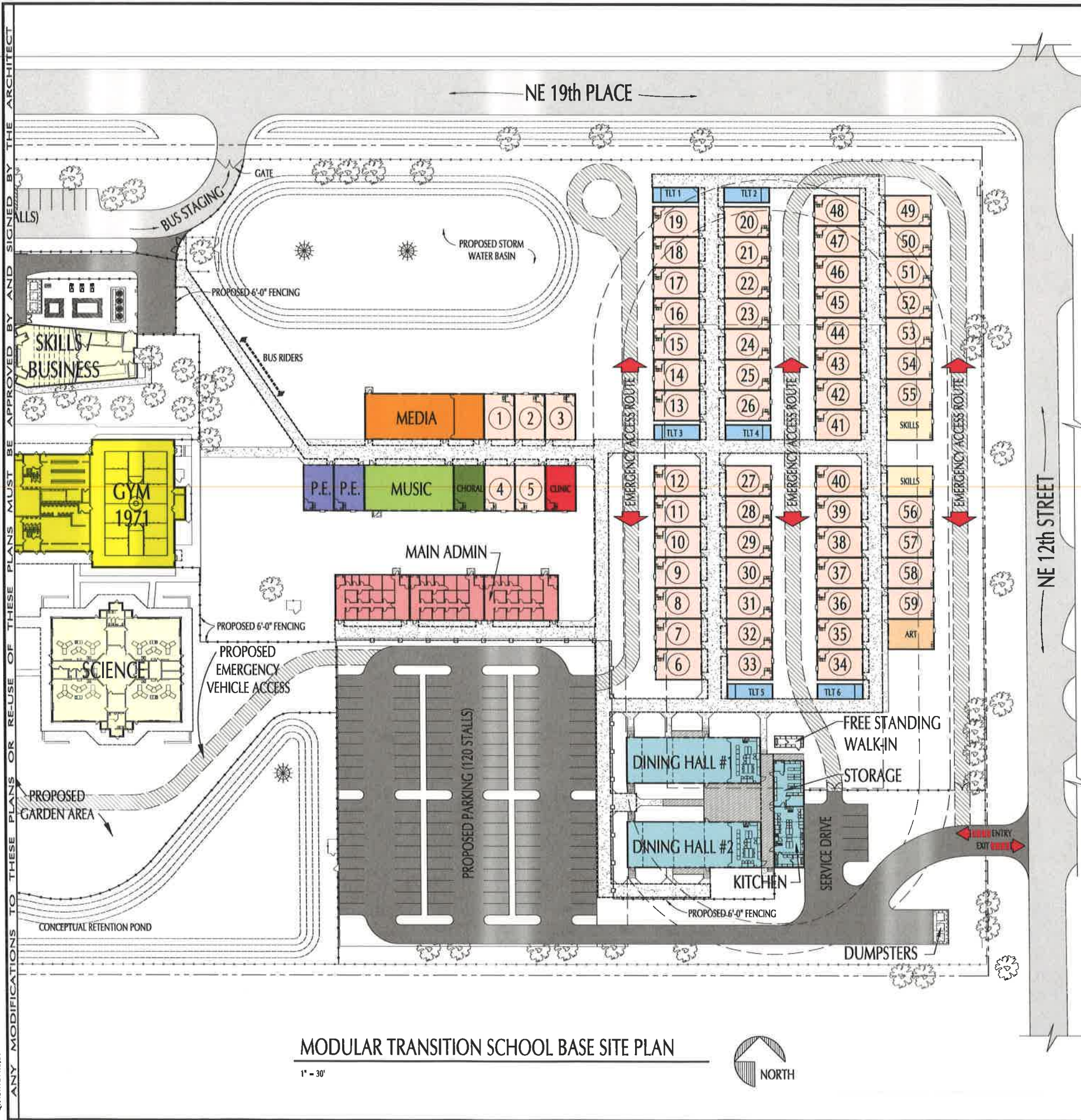

MODULAR TRANSITION SCHOOL BASE SITE PLAN

1" = 30'



SUMMARY OF UNITS	
59	MODULAR CLASSROOMS (36'X24')
2	MODULAR P.E. (36'X24')
2	SKILLS (36'X24')
1	CLINIC (36'X24')
1	ART (36'X24')
1	CHORAL (36'X24')
1	MUSIC (36'X70')
1	MEDIA (36'X93')
3	ADMIN (36'X60')
2	DINING HALL/WARMING KIT. (36'X105')
1	KITCHEN & DRY STORAGE (36'X84')
6	RESTROOM (12'X36')
0	COVERED P.E. PAVILION

NOTE: (66) TOTAL MODULAR CLASSROOMS (36'X24')

# HOWARD BISHOP MIDDLE SCHOOL PHASE 2 (1200) STUDENT STATIONS

PAUL STRESING ASSOCIATES, INC.  
ARCHITECT  
1001 N. W. 10th Ave., Suite 100  
Fort Lauderdale, FL 33304  
TEL: 954-561-1234  
FAX: 954-561-1235  
WWW.PSASOCIATES.COM

ALACHUA COUNTY PUBLIC SCHOOLS  
HOWARD BISHOP MIDDLE SCHOOL  
TRANSITION SCHOOL CAMPUS FEASIBILITY ASSESSMENT  
GAINESVILLE, FLORIDA

REVISIONS  
REV# DATE  
ARCHITECT'S SEAL  
LIC. NO. AR0011785  
SHEET NO.  
03 / 03 / 20



ANY MODIFICATIONS TO THESE PLANS OR RE-USE OF THESE PLANS MUST BE APPROVED BY AND SIGNED BY THE ARCHITECT

# HOWARD BISHOP SCHOOL SITE

## SITE ADVANTAGES

- 1 HOWARD BISHOP STUDENTS REMAIN ON SITE UTILIZING EAST PORTION OF SITE W/ SAFETY FENCE BARRIER
- 2 SCHOOL STAYS IN ITS CURRENT NEIGHBORHOOD
- 3 EASY ACCESS REQUIRING MINIMAL SITE ENHANCEMENTS
- 4 ON SITE CONTRACTOR REPRESENTATION AS TRANSITION SCHOOL RAMPS UP
- 5 THIS SITE CAN BE EXPANDED UP TO 1200 STUDENT STATIONS
- 6 ABILITY TO USE GYMNASIUM W/ UTILITY ENHANCEMENT
- 7 EXISTING BUS STAGING LOOP REMAINS AND UTILIZED W/ STAGGERED STARTS ELIMINATING THE NEED FOR NEW BUS STAGING
- 8 ABILITY TO USE EXISTING HARD COURT FOR PARKING TO REDUCE STORM WATER BASIN SIZE & ELIMINATING A NEW PARKING LOT
- 9 INCREASE PARKING CAPACITY SIZE
- 10 AT THE END USE RESTORATION TO INCLUDE NEW TRACK AND HARD COURT
- 11 SIMPLIFICATION OF THE TRANSITION SCHOOL PROCESS FIRST YEAR
- 12 MORE ROADWAY NETWORK CAPACITY AVAILABILITY
- 13 ON SITE PARKING ALONG NE 12TH ST IS AVAILABLE

## SITE DISADVANTAGES

- 1 ONCE MODERNIZATION IS COMPLETE SCHOOL WILL HAVE TO HOST ADDITIONAL SCHOOL YEARS OF TRANSITION SCHOOL USE
- 2 AFTER THE FIRST YEAR NEIGHBORHOOD WOULD EXPERIENCE ADDITIONAL TRAFFIC, HOWEVER DUAL SCHOOLS WOULD BE STAGGERED
- 3 TEMPORARY REDUCTION OF FULL SPORTS FIELDS USE WHILE TRANSITION SCHOOL IS ACTIVE (REDUCED SIZE)
- 4 FULL KITCHEN MODULAR WILL BE REQUIRED (PURCHASED) ONCE COMPLETED FOOD SERVICE DEPT CAN RE-PURPOSE
- 5 SHARED SCHOOL SECURITY ENHANCEMENT (SCHOOL FENCING & ADMIN PRESENCE) TO SUBDIVIDE THE SCHOOL ( MIDDLE SCHOOL TO MIDDLE SCHOOL VS. MIDDLE SCHOOL TO ELEMENTARY SCHOOL)
- 6 GREASE TRAP & MAINTENANCE WILL BE REQUIRED
- 7 POSSIBLE ENHANCEMENT TRAFFIC CONTROL ENFORCEMENT
- 8 SHARED BUS LOOP ONLY HOLDS 12 BUSES (STAGGERING FOR 1200 STUDENT STATION OPTION)
- 9 LOSS / DELAY OF WILD SPACES PUBLIC PLACES FUNDS / PROJECT
- 10 NO SPACE FOR TRANSITION SCHOOL COVERED COURT
- 11 STAGGERED START SCHEDULE

ALACHUA COUNTY PUBLIC SCHOOLS

HOWARD BISHOP MIDDLE SCHOOL  
TRANSITION SCHOOL CAMPUS FEASIBILITY ASSESSMENT  
GAINESVILLE, FLORIDA

REVISIONS

REV # DATE

ARCHITECT'S SEAL

PSA

LIC. NO. AB0013985

SHEET NO.

03/03/20

PAUL STRESING ASSOCIATES, INC.

ALACHUA, FLORIDA 32606  
TELEPHONE: (352) 482-6437 FAX: (352) 482-6439  
REGISTRATION NO. A00019886 - CA. NO. A0000377

TITLE

DATE

BY

DATE

BY



ANY MODIFICATIONS TO THESE PLANS OR RE-USE OF THESE PLANS MUST BE APPROVED BY AND SIGNED BY THE ARCHITECT

COPYRIGHT © 2010 PALL STRESSING ASSOC.

03/03/20





SUMMARY OF UNITS	
42	PORTABLE CLASSROOMS (36'X24')
2	PORTABLE P.E. (36'X24')
0	SKILLS (36'X24')
1	CLINIC (36'X24')
0	ART (36'X24')
1	CHORAL (36'X24')
1	MUSIC (36'X70')
1	MEDIA (36'X93')
2	ADMIN (36'X60')
1	DINING HALL/WARMING KIT. (36'X105')
1	KITCHEN & DRY STORAGE (36'X84')
6	RESTROOM (12'X36')
1	COVERED P.E. PAVILION
NOTE: (46) TOTAL MODULAR CLASSROOMS (36'X24')	

**TRAFFIC SAFETY/RAWLINGS/FEARNSIDE**  
**PHASE I (770) STUDENT STATIONS**



N. E. 12th STREET



ALACHUA COUNTY PUBLIC SCHOOLS  TRAFFIC SAFETY / RAWLINGS / FEARNSIDE  TRANSITION SCHOOL CAMPUS FEASIBILITY ASSESSMENT  GAINESVILLE, FLORIDA	REVISIONS TOTAL	DRAWN BY: T202X
	REVISED DATE: _____	DATE: T202X
ARCHITECT'S SEAL 	L.C. NO. A280112885 SHEET NO. 03/03/20	PAUL STREISINGER ASSOCIATES, INC. 14817 MAIN STREET ALACHUA, FLORIDA 32916 E-MAIL: PSTREISINGER@PSA-FL.COM TELEPHONE: (386) 482-8407 FAX: (386) 482-8408 REGISTRATION NO. AR0013885 - CA NO. A40003377





SUMMARY OF UNITS	
59	PORTABLE CLASSROOMS (36'X24')
2	PORTABLE P.E. (36'X24')
2	SKILLS (36'X24')
1	CLINIC (36'X24')
1	ART (36'X24')
1	CHORAL (36'X24')
1	MUSIC (36'X70')
1	MEDIA (36'X93')
3	ADMIN (36'X60')
2	DINING HALL/WARMING KIT. (36'X105')
1	KITCHEN & DRY STORAGE (36'X84')
6	RESTROOM (12'X36')
1	COVERED P.E. PAVILION
NOTE: (66) TOTAL MODULAR CLASSROOMS (36'X24')	

**TRAFFIC SAFETY/RAWLINGS/FEARNESIDE**  
PHASE II (1200) STUDENT STATIONS



N. E. 12th STREET

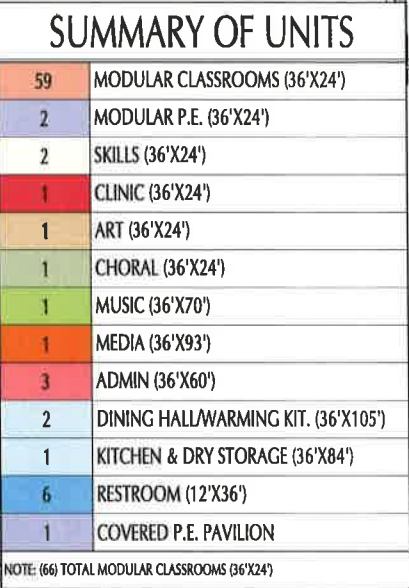

N. E. 15th STREET

ALACHUA COUNTY PUBLIC SCHOOLS

TRAFFIC SAFETY / RAWLINGS / FEARNSIDE  
TRANSITION SCHOOL CAMPUS FEASIBILITY ASSESSMENT  
GAINESVILLE, FLORIDA

GAINESVILLE, FLORIDA

MODULAR TRANSITION SCHOOL BASE SITE PLAN

 $1^{\circ} - 40^{\circ} - 0^{\circ}$ 

# TRAFFIC SAFETY / RAWLINGS / FEARNESIDE

## PHASE I (1200) STUDENT STATIONS

100

REV. DATE:

ARCHITECT'S SEAL

LIC NO: AR0013983

SHEET NO.

03/03/20



ANY MODIFICATIONS TO THESE PLANS OR RE-USE OF THESE PLANS MUST BE APPROVED BY AND SIGNED BY THE ARCHITECT

# TRAFFIC SAFETY // RAWLINGS // FEARNESIDE

## SITE ADVANTAGES

- 1 BUS TRAFFIC PATTERN WILL REMAIN UNCHANGED
- 2 SCHOOL ALLOWS FOR A LONGER TERM OF USE & DISTRIBUTION OF COST
- 3 SITE ALLOWS FOR A CONSTRUCTION AND MODULAR UNIT STAGING DURING CONSTRUCTION
- 4 NEW P.E. PAVILION & P.E. TRACK
- 5 SHARED SERVICE DRIVES W/ EASY ACCESS OFF 39TH AVE (MAJOR EAST / WEST FEEDER ROAD)
- 6 ONLY SITE W/ ABILITY TO ACCOMMODATE ON SITE VEHICLE STAGING KEEPING ANY STRUCTURED CONGESTION ON SITE AND OFF THE PUBLIC ROAD USE
- 7 123 VEHICLE STALL PARKING LOT THAT CAN REMAIN AFTER USE
- 8 ABILITY TO MAINTAIN A TREE BUFFER BETWEEN PROPOSED PARKING LOT AND NEIGHBORHOOD
- 9 LIFT STATION MODERNIZATION FOR RAWLINGS SCHOOL AND ENTIRE SITE
- 10 WEEKEND USE OF NEW PARKING LOT BY DRIVERS EDUCATION TRAINING
- 11 EASY ACCESS OF FUTURE MODULARS WITH MINIMAL DISRUPTION TO EXPAND SITE FROM 770 STUDENT STATIONS TO 1200 STUDENT STATIONS
- 12 AT END OF PROJECT THE ORIGINAL SITE WILL BE RESTORED WITH PARKING TO REMAIN, TRACK AND P.E. PAVILION TO REMAIN
- 13 AT END OF PROJECT PURCHASED FOOD PREP UNIT TO BE RELOCATED TO FOOD SERVICE DEPT AS A TEST KITCHEN OR FOR FUTURE USE
- 14 EASY EMERGENCY VEHICLE ACCESS TO AND BETWEEN MODULARS
- 15 OPTION WITH LEAST IMPACT ON THE EXISTING ADJACENT SCHOOL
- 16 SOME HOWARD BISHOP STUDENTS CAN WALK TO RAWLINGS SITE
- 17 SCHOOL REQUIRES LESS COORDINATION & DOES NOT REQUIRE LAW ENFORCEMENT OFFICER TRAFFIC CONTROL

## SITE DISADVANTAGES

- 1 ONCE MODERNIZATION EFFORTS ARE COMPLETE SCHOOL WILL HOST ADDITIONAL SCHOOL YEARS OF TRANSITION SCHOOL USE
- 2 ADDITIONAL CAR TRAFFIC ON A SHORT SEGMENT OF NE 12TH STREET
- 3 EXISTING FORCE MAIN UPGRADE COST
- 4 ADDITIONAL COST FOR UPGRADING EXISTING UTILITIES (ADVANTAGE & DISADVANTAGE)
- 5 PURCHASE OF A MODULAR KITCHEN UNIT & GREASE TRAP (NOT REQUIRED AT WESTWOOD SITE)
- 6 SHARED SCHOOL SECURITY ENHANCEMENT (CONTROLLED W/ FENCING & ADMIN PRESENCE TO SUBDIVIDE SCHOOLS; MIDDLE SCHOOL TO MIDDLE SCHOOL VS MIDDLE SCHOOL TO ELEMENTARY SCHOOL)
- 7 LACK OF SIDEWALKS ALONG NE 12TH STREET (WEST SIDE OF SITE) CAN BE ADDED
- 8 GREASE TRAP & MAINTENANCE WILL BE REQUIRED

ALACHUA COUNTY PUBLIC SCHOOLS  
TRAFFIC SAFETY / RAWLINGS / FEARNESIDE  
TRANSITION SCHOOL CAMPUS FEASIBILITY ASSESSMENT  
GAINESVILLE, FLORIDA

REVISIONS  
REV# DATE  
ARCHITECT'S SEAL  
LIC. NO. AB0013985  
SHEET NO.

03/03/20

PAUL STRESING ASSOCIATES, INC.  
1001 N. MAIN STREET  
ALACHUA, FLORIDA 32315  
PHONE (386) 462-4407 FAX (386) 462-4409  
REGISTRATION NO. A40013985 - CA NC A4005377



ANY MODIFICATIONS TO THESE PLANS OR RE-USE OF THESE PLANS MUST BE APPROVED BY AND SIGNED BY THE ARCHITECT

# TRAFFIC SAFETY / RAWLINGS / FEARNESIDE OPINION OF PROBABLE COST

	TASK / EVENT	BUDGET	REMARKS
1	(46) MODULAR (770 SS SCHOOL)	\$7,163,284	(42) CLSRM /(6) TLT /(1) DINING &WRM KIT/(2) ADMIN/(1) CLINIC/(1) MEDIA/(1) MUSIC/(2) PE/(1) CHR
2	FF&E (46 UNITS X \$9000)	\$ 414,000	INSTRUCTURAL AIDS, FURNITURE, (6) COMPUTER STATIONS, TEACHER COMPUTER SERVER, ETC.
3	(20) ADD MODULAR (1200 SS SCHOOL)	\$1,264,374	(20) CLSRM UNITS/(1) ADDITIONAL DINING HALL&WARM KIT/(1) ADMIN/(2) SKILLS DEV
4	FF&E (20 UNITS X \$9000)	\$ 180,000	INSTRUCTURAL AIDS, FURNITURE, (6) COMPUTER STATIONS, TEACHER COMPUTER SERVER, ETC.
5A	KITCHEN COOK UNIT	\$ 400,000	ASSUMED RELOCATED FROM HOWARD BISHOP MIDDLE SCHOOL
5B	GREASE TRAPS (2@1250 GAL)	\$ 85,000	
6A	SITE PREP, PAVEMENT, & MISC (\$1,468,800)	- (SEE ITEM 6)	EXTENSIVE GRADING REQUIRED (ASSUMED)
6B	STORM INFRASTRUCTURE (\$274,050)	- (SEE ITEM 6)	
6C	WATER UTILITIES (\$207,900)	- (SEE ITEM 6)	
6D	SEWER UTILITIES (\$754,650)	- (SEE ITEM 6)	
6E	OFF SITE SIDEWALK (135,000)	- (SEE ITEM 6)	
6F	RESTORATION OF SITE & FIELDS (\$405,000)	- (SEE ITEM 6)	INCLUDES NEW BASEBALL FIELD, PLUS SITE RESTORATION,
6	TOTAL CIVIL (TOTAL OF ITEMS 6A THRU 6F)	\$ 3,245,400	ITEMS 6A THRU 6E PLUS CONTOURING, GENERAL CONDITION, BOND, MOBILIZATION
7A	CONC SIDEWALKS (NO COVERED CANOPIES)	\$ 73,182	
7B	CONC SIDEWALKS (W/ COVERED CANOPIES)	\$ 130,020	
8	SITE ELECTRICAL (POWER)	\$ 335,000	
9	SITE DATA / INTERCOM / FIRE ALARM	\$ 268,250	
10	COVERED WALK-WAY SYSTEM	\$ 1,591,650	
11	MISC CONTINGENCY INCIDENTALS	\$ 250,000	
12	KITCHEN EQUIPMENT	\$ 206,250	ASSUMED RELOCATED FROM HOWARD BISHOP MIDDLE SCHOOL
13	TRANSPORTATION IMPACT (PER YEAR)	\$ 295,357	YEARLY COST SUBJECT TO MARKET FLUCTUATION
14	RAMPS & STAIRS & OPEN DECK @ FOOD SVS	\$ 130,500	
15	FENCING (6'-0" HIGH / 4'-0" HIGH)	\$ 8,349	
16	DECORATIVE FENCE & GATES W/ PANIC HW	\$ 17,618	
17	EXTENDED TRAFFIC SAFETY (PER YEAR)	\$ 116,000	CROSSING GUARDS & LAW ENFORCEMENT
	TOTAL PROGRAM FOR 3 YEARS OPERATION (770 SS)	\$5,184,191	( \$ 15,552,574 / 3 YEARS = \$5,184,191 )
	TOTAL PROGRAM FOR 5 YEARS OPERATION (770 SS)	\$3,563,932	( \$ 17,819,662 / 5 YEARS = \$3,563,932 )
	TOTAL PROGRAM FOR 7 (5 + 2) YEARS OPERATION (1200 SS)	\$2,663,197	( \$ 18,642,376 / 7 YEARS = \$2,663,197 )

COPYRIGHT © 2007 PAUL STRESING ASSOC

PAUL STRESING ASSOCIATES, INC.  
14817 MAIN STREET  
ALACHUA, FLORIDA 32019  
TELEPHONE (386) 482-4427 FAX (386) 482-5009  
REGISTRATION NO. A00019865 - CA NO. A0001377

ALACHUA COUNTY PUBLIC SCHOOLS  
TRAFFIC SAFETY / RAWLINGS / FEARNESIDE  
TRANSITION SCHOOL CAMPUS FEASIBILITY ASSESSMENT  
GAINESVILLE, FLORIDA

REVISED  
ITEM  
REV. # DATE  
ARCHITECT'S SEAL  
LIC. NO. A00019865  
SHEET NO.  
03/03/20